

# ALKALINE-MANGANESE DIOXIDE BATTERY

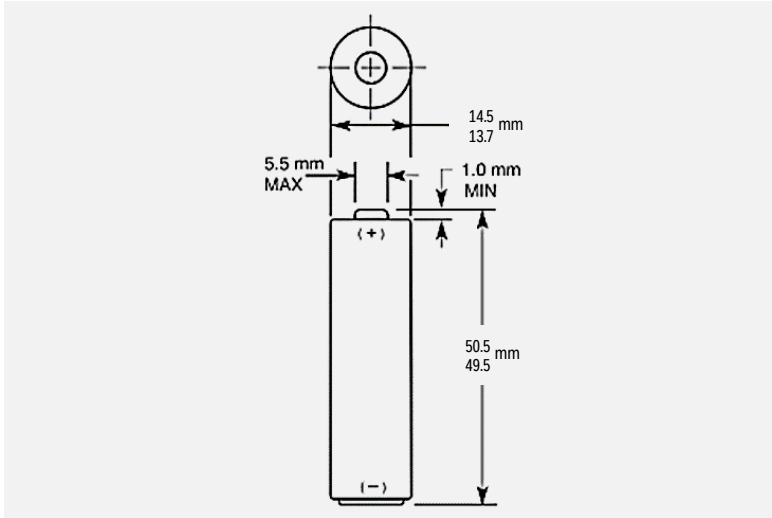

Size: AA (LR6) DURPX1500



Dimensions shown are IEC standards

## KEY FEATURES

- Reliable Performance
- Excellent resistance to corrosion
- Designed to meet all major quality, safety and environmental standards:
  - Safety: IEC 60086-5
  - ANSI C 18.1M, Part-2
  - EU Battery Directive
  - Quality: ISO 14001 and 9001, Duracell World Class Continuous Improvement Program

## TYPICAL APPLICATIONS

- Medical Devices
- Security Cameras
- Soap Dispensers
- Electronic Door Locks
- Window Blinds/Shades



130 Bush Road  
 Albany, 0632  
 Telephone: 0800 239 239  
[www.hamer.co.nz](http://www.hamer.co.nz)

## ELECTRICAL CHARACTERISTICS

▪ Nominal capacity (25 mA Cont., .8V cut-off)	3,112 mAh
▪ Typical Voltage (at + 20 °C)	1.5 V
▪ AC Impedance @ 1kHz	68 mΩ

## PHYSICAL CHARACTERISTICS

▪ Typical weight	24.3 g (0.9 oz)
▪ Typical volume	8.4 cm <sup>3</sup> (0.5 in <sup>3</sup> )
▪ Terminals	Flat

## OPERATING & STORAGE CONDITIONS

▪ Operating temperature range	-20°C to 54°C (-4°F to 130°F)
▪ Recommended Storage (storage area should be clean, cool, dry and ventilated)	5°C to 30°C (41°F to 86°F)

Delivered capacity is dependent on the applied load, operating temperature and cut-off voltage. Please refer to the charts and discharge data shown for examples of the energy/service life that the battery will provide for various load conditions.

This data is subject to change. Performance information is typical. Contact Hamer for the latest information.